



AIR PURIFIER

- USER'S MANUAL



MODEL:
QLT-700



| LANGUAGES

ENGLISH 4

| Safety Warning

Safety Matters for Attention

Note

This section describes the contents and importance of the safety matters to prevent personal injuries or property damages to the users or others. Please read the text on the basis of full understanding of the following contents (marks and icons), and be sure to abide by the safety matters as described.

Indicate [Prohibited] contents



No inflammable articles



No wet area



No open flames

- Do not use this appliance in wet or high temperature environment (like bathroom, toilet and kitchen).
- Before replacing the filter, please stop this appliance and cut off power.
- Do not place other items on top of the appliance, and sitting or standing on this appliance is forbidden.
- Please use the original filter provided by the factory. In case other filters are used, the best results cannot be achieved.
- Do not use damaged or aged power cords; Do not replace the power cord without authorization. If the power cord is damaged, it must be replaced by the manufacturer, its service department or professionals from similar departments to avoid danger.
- This appliance is only limited to 220-240V power supply, and please unplug the appliance when it is not used for a long time.
- Do not insert your fingers or objects into the air inlets or air outlets to prevent the product from physical damages or malfunction.
- Please unplug the appliance immediately and contact the service center in time when the appliance gives off abnormal sound or burnt smell or smoke.
- Do not spray flammable substances near the appliance; Do not spray water directly on the appliance or use chemical cleaners like alcohol or hydrochloric acid, etc.; Do not place water containers, medicines, or flammable materials on the appliance.
- Do not block the air inlets/outlets of the appliance with any item.
- This appliance can be used by children aged from 8 years and above and persons with reduced physical, sensory or mental capabilities or lack of experience and knowledge if they have been given supervision or instruction concerning use of the appliance in a safe way and understand the hazards involved. Children shall not play with the appliance. Cleaning and user maintenance shall not be made by children without supervision. Prior to cleaning or other maintenance, the appliance must be disconnected from the supply mains.



⚠ Matters that may Cause Minor Injury or Property Damages

- This appliance cannot replace natural ventilation and other appliances like the vacuum cleaner, kitchen ventilator, etc.
- When the appliance is working, it must be placed on a dry, flat and stable floor, with at least 30cm space reserved around it.
- Do not put it in a place with direct sunlight.
- To prevent electromagnetic disturbance, the appliance must keep a certain distance from the TV, radio, microwave oven and other appliances.
- The mist produced by the ultrasonic humidifier may affect the PM2.5 detection of this appliance, and both should maintain a certain distance.
- Do not disassemble or modify this appliance without authorization to avoid accidents.
- Do not move the appliance by pulling the power cord.
- Please take care of the children and make sure that the children do not touch the appliance to avoid accidents.

⚠ Statement

Executive standards of the product: GB 4706.1-2005, GB 4706.45-2008, GB 21551.3-2010, and GB/T 18801 2015. With the technical innovation and improvement of the product, the manual content of the same type as this product may be changed. The updated parts will not be separately notified. The legends shown in this manual are based on the appearance of standard purifiers and only used for illustrative purposes. The actual appearance shall be based on the purchased product. Due to product improvement, some parameters may be changed. The changed parameters have no retroactivity to this product. Please take the parameters on the nameplate of products as the criterion. If there is any change in the manual contents, our company will give the notice through the company's official website without separate notice; Unless explicitly stated in the notice, the changed contents have no retroactivity to this product in principle. The right to interpret the relevant provisions of this manual belongs to Inventor A.G. S.A.

| Safety Matters for Attention

 Danger	If the appliance is not used according to the prescriptions, it may cause serious personal injury or even death.
 Warning	If not used according to the prescribed contents, it may cause personal injury or property damages.



 Do not use this appliance in wet or high temperature environment (like bathroom, toilet and kitchen).

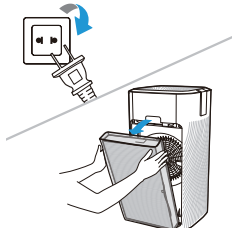

 Before replacing the filter, please stop this appliance and cut off power.

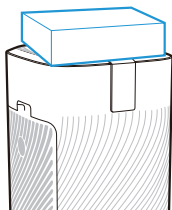

 Do not place other items on top of the appliance, and sitting or standing on this appliance is forbidden.

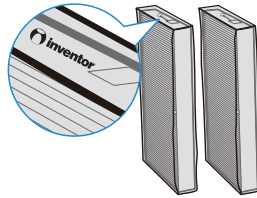

 Please use the original filter provided by the factory. In case other filters are used, the best results cannot be achieved.

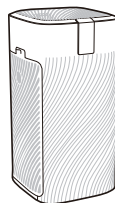

 This appliance cannot replace natural ventilation and other appliances like the vacuum cleaner, kitchen ventilator, etc.

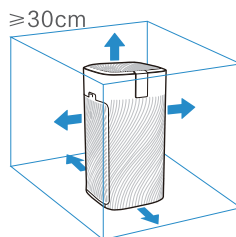

 When the appliance is working, it must be placed on a dry, flat and stable floor, with at least 30cm space reserved around it.



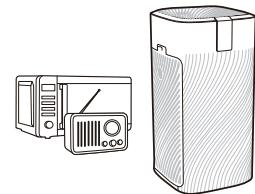

 Do not put it in a place with direct sunlight.



 To prevent electromagnetic disturbance, the appliance must keep a certain distance from the TV, radio, microwave oven and other appliances.



 The mist produced by the ultrasonic humidifier may affect the PM2.5 detection of this appliance, and both should maintain a certain distance

 **Note:** Never Wash the HEPA filter

| Important Matters



Note

This section describes the contents and importance of the matters needing attention to prevent personal injuries or property damages to the users or others. Please read the text on the basis of full understanding of the following contents (marks and icons), and be sure to abide by the safety matters as described.

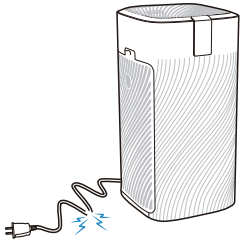

Do not use damaged or aged power cords: Do not replace the power cord without authorization. If the power cord is damaged, it must be replaced by the manufacturer, its service department or professionals from similar departments to avoid danger.

220V ~ 50Hz

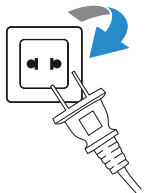

This appliance is only limited to 220-240V power supply, and please unplug the appliance when it is not used for a long time.

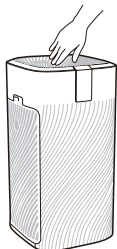

Do not insert your fingers or objects into the air inlets or air outlets to prevent the product from physical damages or malfunction.

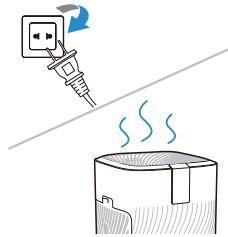

Please unplug the appliance immediately and contact the service center in time when the appliance gives off abnormal sound or burnt smell or smoke.

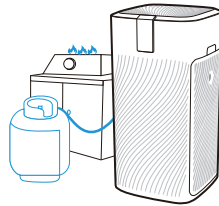

Do not spray flammable substances near the appliance; Do not spray water directly on the appliance or use chemical cleaners like alcohol or hydrochloric acid, etc.; Do not place water containers, medicines, or flammable materials on the appliance.

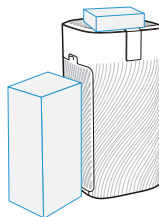

Do not block the air inlets/outlets of the appliance with any item;

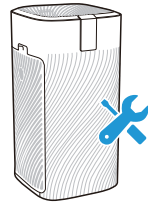

Do not disassemble or modify this appliance without authorization to avoid accidents.

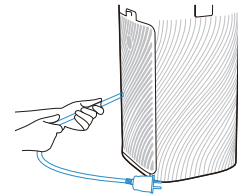

Do not move the appliance by pulling the power cord.

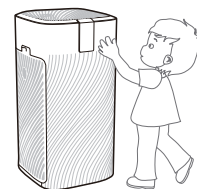

Please take care of the children and make sure that the children do not touch the appliance to avoid accidents.

| Product Introduction

⚠ Note

Due to the different appearance of products, the pictures below are for reference only, and they will be subject to the physical products in the packing box

Name of parts

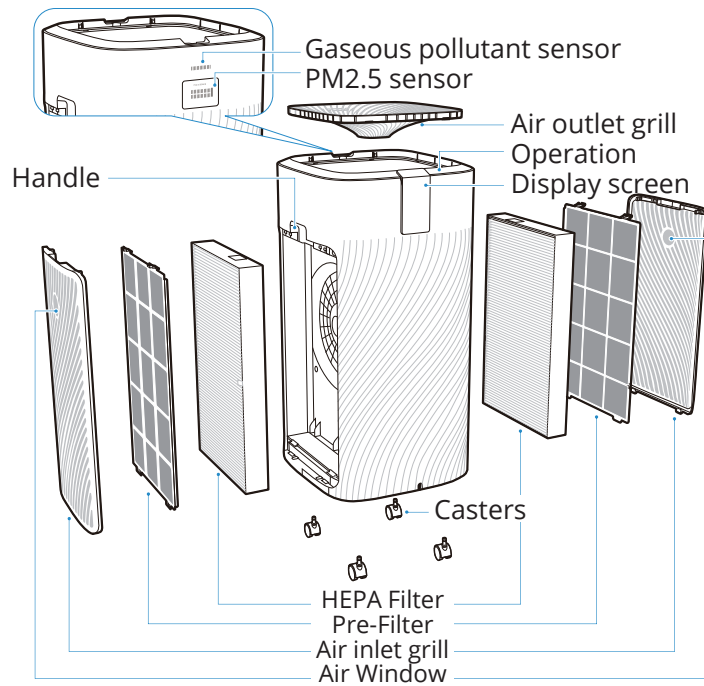

Product list

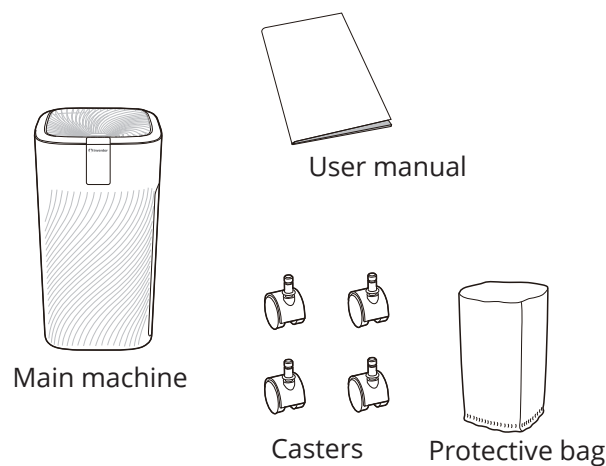

- Main machine (1)
- User manual (1)
- Casters (4)

- Protective bag (1)
- Filter screen (1set/2pcs) (Installed in the main machine)

Control panel

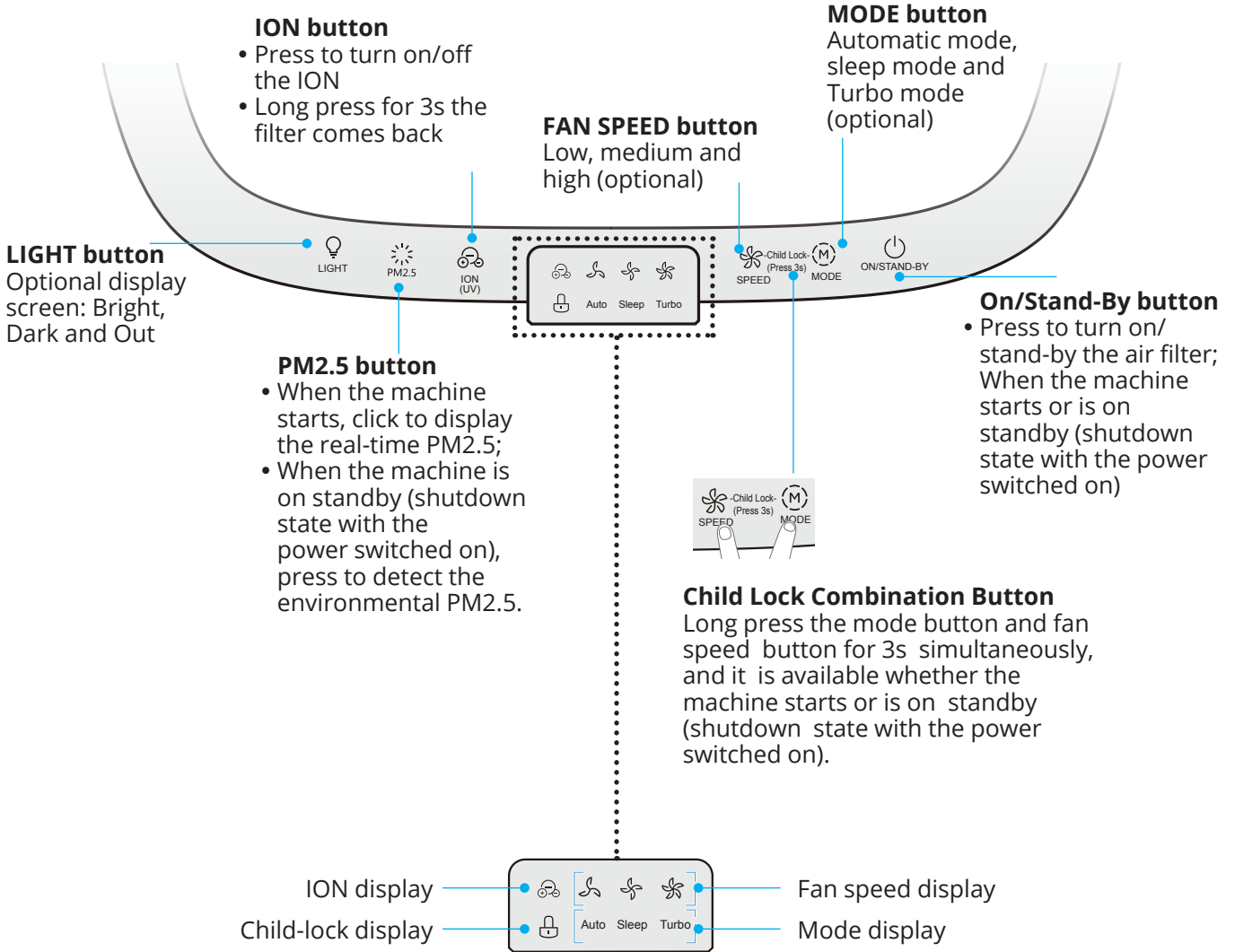

Display panel

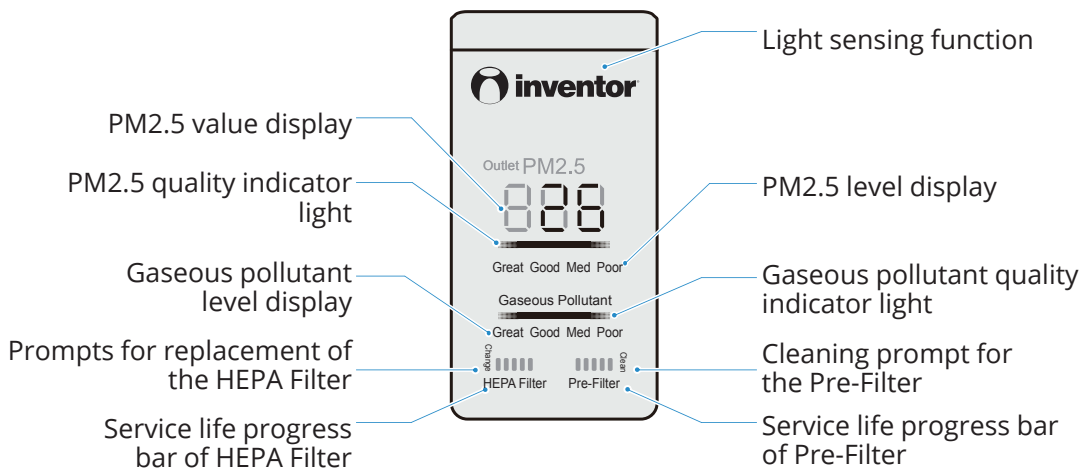

| Assembly Instructions

Assembly procedures

1 Take down the air inlet grill.

Grasp the clasp position and pull outward to remove the air inlet grill.

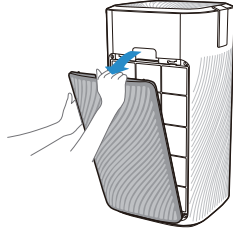

2 Take out the Pre-Filter.

Press down and pull the U-shaped snap joint, and take out the Pre-Filter.

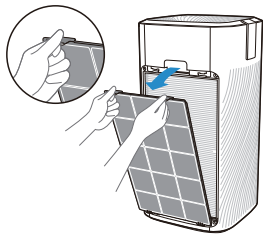

3 Take out the HEPA Filter.

Hold both sides of the HEPA Filter with both hands, and take out the HEPA Filter.

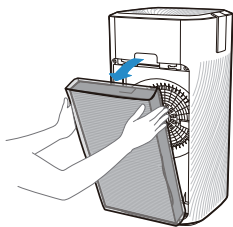

4 Remove the protective film of the filter.

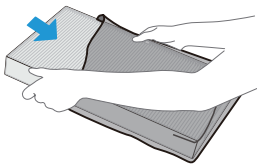

5 Assemble the HEPA Filter.

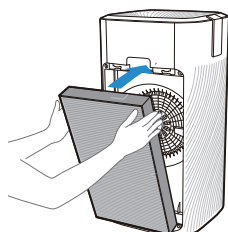

6 Assemble the Pre-Filter.

Align the slot position at the bottom, and click into the upper U-shaped snap joint.

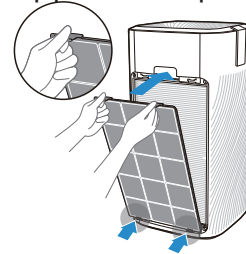

7 Assemble the air inlet grill.

Align with the slot position at the bottom, press both sides of the upper part of the air inlet grill, and clasp the air inlet grill.

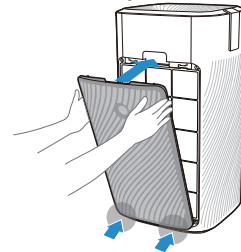

8 Assemble the filter on the other side.

Repeat Steps 1-7 to assemble the filter on the other side.

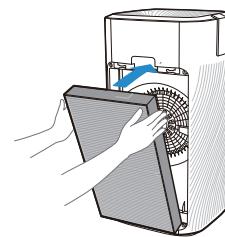

9 Install the caster

Tilt the machine body to install the casters and press into 4 casters with force in turn at the bottom.

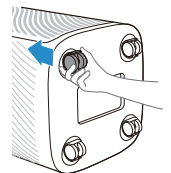

10 Then power on for operation.

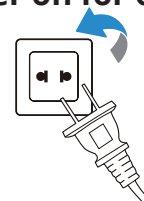

| Operating Manual

Trial operation

⚠ Note

- This appliance is provided with a disassembly protection function; the appliance can only operate normally after the air inlet grill and air outlet grill are assembled properly.
- With the power on, each time after the machine starts, it enters the working mode before the standby state.
- When powered on again after unexpected power failure (such as power failure at home or the appliance is unplugged during normal operation), it automatically restores to the working state where the power failure occurs.

1 Preparation

Power on for the first time, the display panel flickers for 1s, and then the screen is turned off. The whole appliance is on standby state.

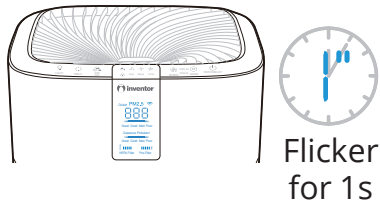
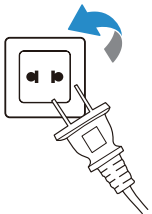

2 Switch

Press the ON/STAND-BY button

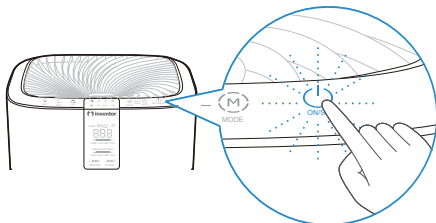

3 Pre-heating



The odor sensor is preheated, Great, Good, Med and Poor status are displayed alternately, and then it displays normally after 1min.



The particle sensor enters the preheating state, PM2.5 value displays "---"; Great, Good, Med and Poor statuses are displayed alternately, and then it displays normally after 15s;

4 Work

The purifier is powered on for the first time and then enters the automatic mode.

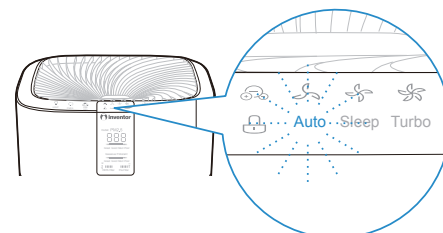

| Cleaning and Maintenance

⚠ Notes

Be sure to turn it off before any maintenance, and cut off power.

Cleaning of the machine body

Main machine

Wipe the body with a soft towel



Air inlet grill

Open the air inlet grill, clean dust with a vacuum cleaner, and wipe it with a cloth.

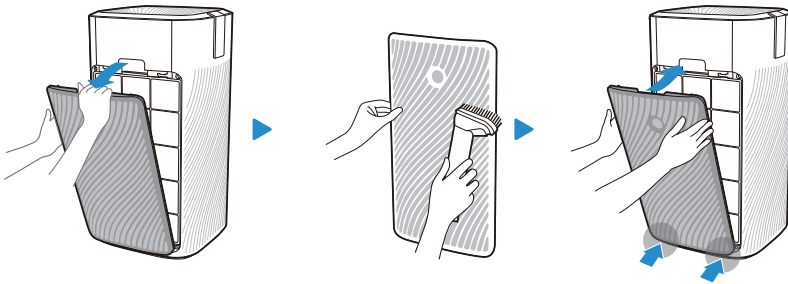

Air outlet grill

Open the air outlet grill, clean dust with a vacuum cleaner, and wipe it with a cloth.



Cleaning of the filter components

1 When the last bar of the progress bar turns red and the cleaning indicator light is on, it prompts that the Pre-Filter needs to be cleaned.



2 Unplug the appliance, and take out the Pre-Filter

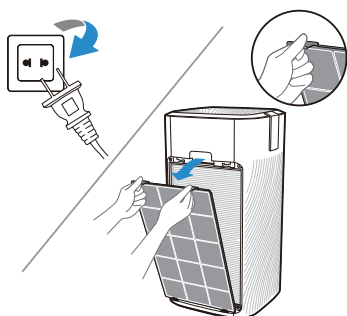

3 Vacuum the dust or wipe it with a cloth.

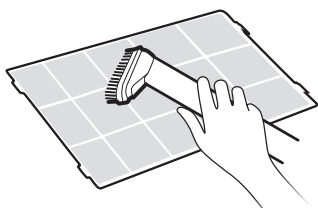

4 If there is a lot of dirt, the common kitchen detergents is diluted and used first, and then do the cleaning.

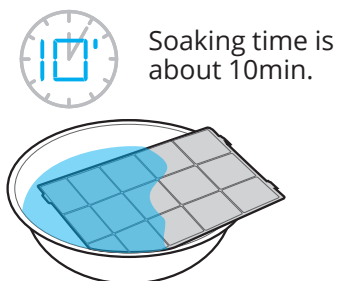

5 Dry the Pre-Filter

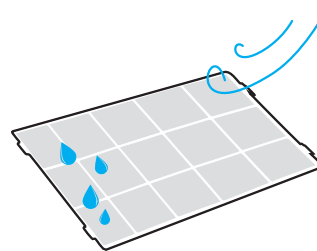

6 Assemble the Pre-Filter

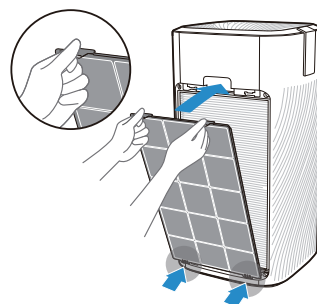

7 Plug in the appliance, and start it.

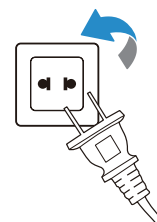

8 Long press the ION button for 3s, the cleaning indicator light is off, and the Pre-Filter is restored.

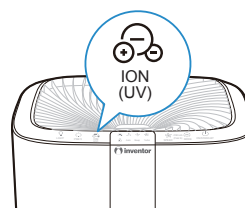

Replacement of the filter components

1 Filter model: QLT-700-F (includes 2)

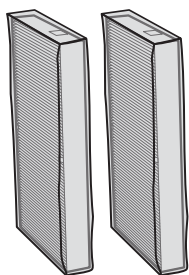

4 Remove the protective film of the filter

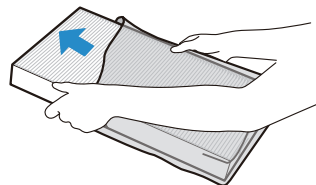

2 When the last bar of the progress bar turns red and the replacement indicator light is on, it prompts that the HEPA Filter needs to be replaced.

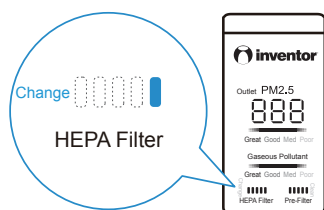

5 After installing the new HEPA Filter provided by the original factory, it can be run with the machine and the HEPA Filter will be reset automatically without any other operation.

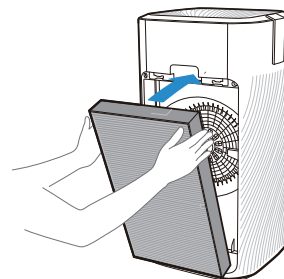

3 Take out the HEPA Filter

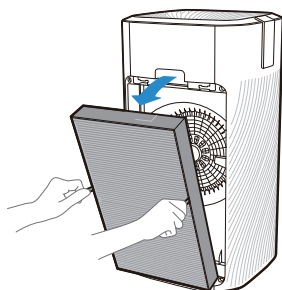

6 Under other circumstances, long press the ION button for 3s, the replacement indicator light is off, and the HEPA Filter is restored.

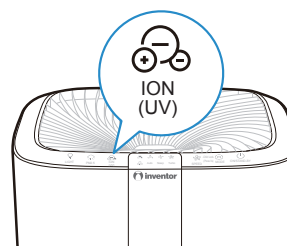

⚠ Notes

Never Wash the HEPA filter

Recommend to clean filter with a small soft brush or the use of a vacuum cleaner. In the event of strong odor from cigarettes, barbecue, etc., the filter may produce a smell. Please remove and clean the filter and air filter and allow 2-5 days prior to use. If the smell persists, please replace the filter.

| Service Guide

Faults Handling

Before inviting someone to inspect or repair, please check the following items.

Faults	Troubleshooting
The display screen shows "E3"	The fan speed is out of control: contact the after-sales office for treatment.
The display screen shows "EO"	Main control EEPROM hardware failure, and contact the after-sales office for treatment.
The display screen shows "E1"	The fault is because of disassembly protection, and the air inlet and outlet grilles are not assembled properly: assemble the air inlet grilles and air outlet grilles properly.
The display screen shows "EU"	PM2.5 air inlet sensor communication failure: contact the after-sales office for treatment
The purifier is not working	Firstly, check whether the power cord is plugged into the power socket, the loose plug caused by the movement of the purifier may affect the energizing; Secondly, check whether the air inlet grill and air outlet grill of the purifier are assembled properly. This appliance is provided with a disassembly protection function. If the air inlet grill and air outlet grill are not assembled properly, the machine cannot work.
The purifier has a small amount of air and is noisy	Firstly, check whether the foreign matters block the air inlet grill and air outlet grill. If any, remove those foreign matters; Then, check whether the Pre-Filter becomes dirty or reaches the end of its service life; and clean the Pre-Filter; Finally, check whether the HEPA Filter is full of dust or reaches the end of its service life. This time the replacement of the HEPA Filter is required.
The air outlet smells odorous	When the appliance is operated for the first time, it smells slightly plastic, which is normal; If this appliance works in places (like smoking area or rotisserie, etc.) with strong smell for a long time, you need to change the filter element frequently and reset it; Check whether the air inlet/outlet grill and Pre-Filter are full of dust or dirt; if any, maintain the appliance and clean the dust and dirt on the air inlet/outlet grill and Pre-Filter.
Whether the wheels are pulled out after inserted	Yes, tilt the machine at a small angle and pull them out with a little effort. If the effort fails, try to pull the wheels out while turning them.
Whether the purifier can be used with the humidifier	The wet environment has a greater impact on the filter element, and the mist produced by the ultrasonic humidifier may cause abnormality in the PM2.5 detection of this appliance, so that simultaneous operation should be avoided as much as possible.

Product Parameters

Model	QLT-700
Voltage	220-240V
Rated power	45W
CADR (particulate matters)	700m ³ /h
Purification energy efficiency rating of the particulate matters	Efficient level
Noise	<57dB

- The various performance parameters in the table are measured in the factory and for reference only.
- Due to product improvement, some parameters may be changed, and take the parameters on the nameplate of products as the criterion.
- Purification principle: The fan of the air purifier draws air into the machine to be filtered through the built-in filter element, which plays a main role in filtering the dust (like PM2.5, etc.), formaldehyde, odor, sterilization and so on.

Environment-friendly List

Name of parts	Harmful substances					
	Plumbum (Pb)	Mercury (Hg)	Cadmium (Cd)	Hexavalent chromium (Cr(VI))	Polybrominated biphenyls (PBB)	Polybrominated Diphenyl Ethers (PBDE)
Shell component	○	○	○	○	○	○
Power cord component	×	○	○	○	○	○
Motor component	○	○	○	○	○	○
Appliance component	○	○	×	○	○	○
Wind wheel component	○	○	○	○	○	○
Circuit board component	×	○	×	○	○	○
Filter component	○	○	○	○	○	○

This table is formulated in line with the SJ/T 11364

"○" Indicates that the content of the hazardous substance in all homogeneous materials of this component is below the limit prescribed in GB/T 26572.

"×

All the pictures in the manual are for explanatory purposes only. The actual shape of the unit you purchased may be slightly different, but the operations and functions are the same. The company may not be held responsible for any misprinted information. The design and the specifications of the product for reasons, such as product improvement, are subject to change without any prior notice.

Please consult with the manufacturer at +30 211 300 3300 or with the Sales agency for further details. Any future updates to the manual will be uploaded to the service website, and it is advised to always check for the latest version.



Scan here to download the latest version of this manual.
www.inventorappliances.com/manuals

Activate your Warranty

Follow the next quick steps to activate your warranty:

STEP 1

Visit our website via the link:

<https://www.inventorappliances.com/warranty-card>

or by scanning the QR code, as follows:

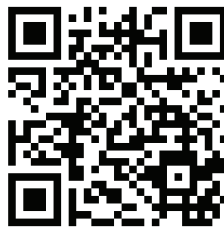

STEP 2

Fill in the obligatory fields as requested in the "Owner's details" and "Unit's details":

To activate the warranty card, please fill in the following fields

Owner's details	Unit details
Full Name	Unit
Address*	Serial Number of the unit*

STEP 3

Click SEND button at the end of the submission form:

E-mail*

Subscribe to our Newsletter

SEND I have read and you accept the terms and conditions.

I would like to receive information once the warranty submission has been completed a confirmation message will be sent to your email

STEP 4

Wait for the confirmation email you will receive at the email address you have filled in - please also check your spam folder.

STEP 5

Inventor warranty is now valid!



AIR PURIFIER



v 1.2

