



## VKSA 500-250-4 L1

Art.no: [FAN000348](#) | Product category: Rectangular duct fans

### Technical data

PACKING		FAN	
Weight	31 kg	Motor type	AC
ELECTRICAL DATA		IP Class	IP54
Rated power	510 W	Impeller type	Forwards curved
Rated current	2.3 A	CASING	
Phases	1N~ ~	Material	Galvanized steel
Voltage	230 V	IP Class	IP54
Frequency	50 Hz	Operation environment	Indoors
		Operating air temperature	-20 .. 40 °C

## Dimensions

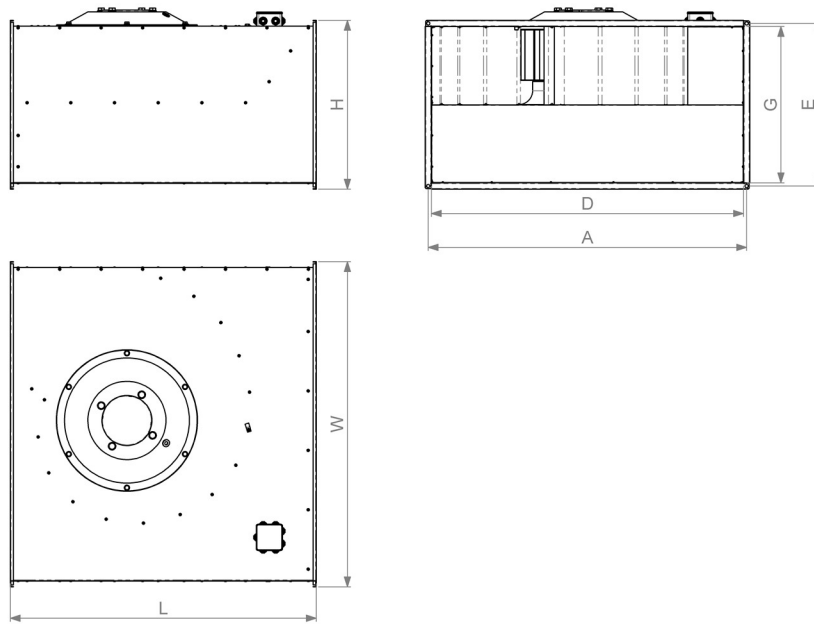

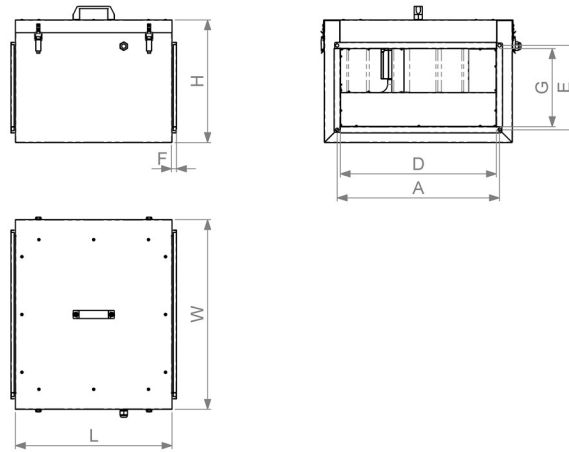

L [mm]	W [mm]	H [mm]	D [mm]	G [mm]	F [mm]	A [mm]	E [mm]
502	607	393	500	250	14	520	270