



VSA 220 M 3.0

Art.no: [FAN000047](#)

Product category: Roof fans

Technical data

PACKING	
Weight	6.5 kg
ELECTRICAL DATA	
Rated power	103 W
Rated current	0.5 A
Phases	1N~ ~
Voltage	230 V
Frequency	50 Hz

FAN	
Motor type	AC
IP Class	IP44
Impeller type	Backwards curved
CASING	
Material	Galvanized steel
Color	RAL 9005 (Black)
IP Class	IP54
Operation environment	Outdoors
Operating air temperature	-25 .. 55 °C

Ecodesign

	Cold	Average	Warm	
SEC	-53.2	-26.1	-10.6	kWh/m ² a
Class	A+	B	E	
AEC	88.1	88.1	88.1	kWh/a
AHS	5536	2830	1280	kWh/a
Topology	NRVU / BVU			
Recovery type	-			
Type of drive	Multi-speed			
Maximum airflow	666		m ³ /h	
Fan power at max airflow	97.2		W	
Casing sound power level	53.5		dB(A)	
Reference airflow	0.13		m ³ /s	
Reference pressure	49.2		Pa	
SPI	0.13		W/(m ³ /h)	
Control factor	0.65			
Declared maximum external leakage rates	1		%	
ErP Compliance	2018			
Internet address for disassembly instructions	www.salda.lt			

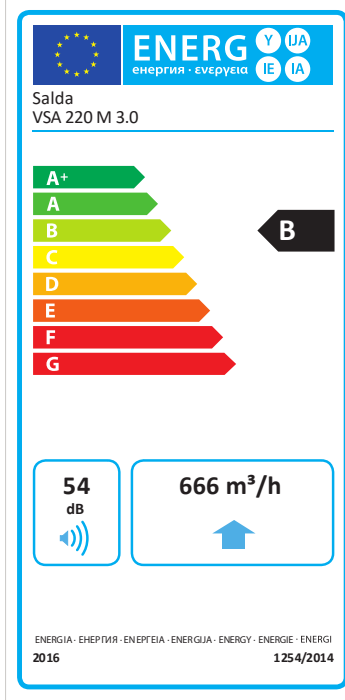

Dimensions

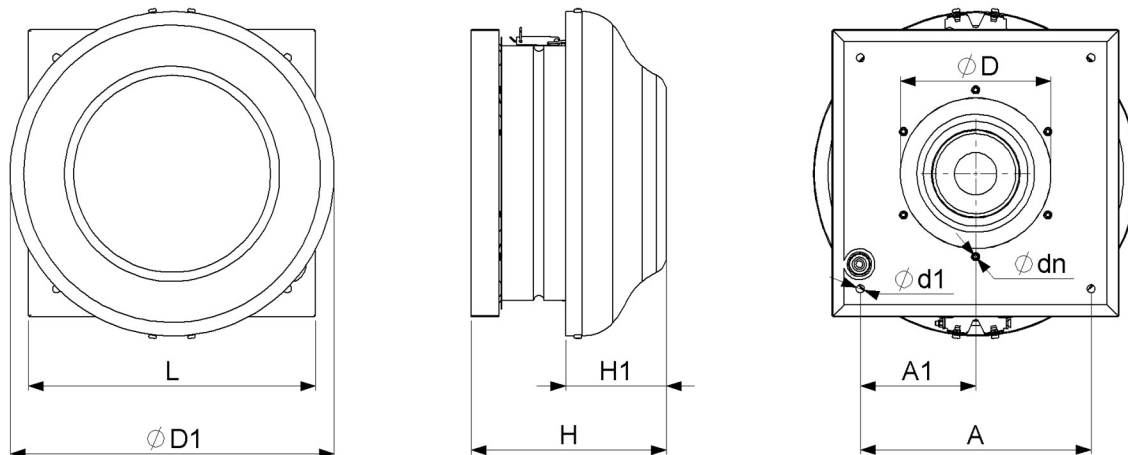

L [mm]	H [mm]	$\varnothing D$ [mm]	dn	H1 [mm]	A [mm]	A1 [mm]	D1 [mm]	d1 [mm]
405	214	200	M5	109	330	165	450	8